

Folding Ottoman

Using Instruction

A061-001-001

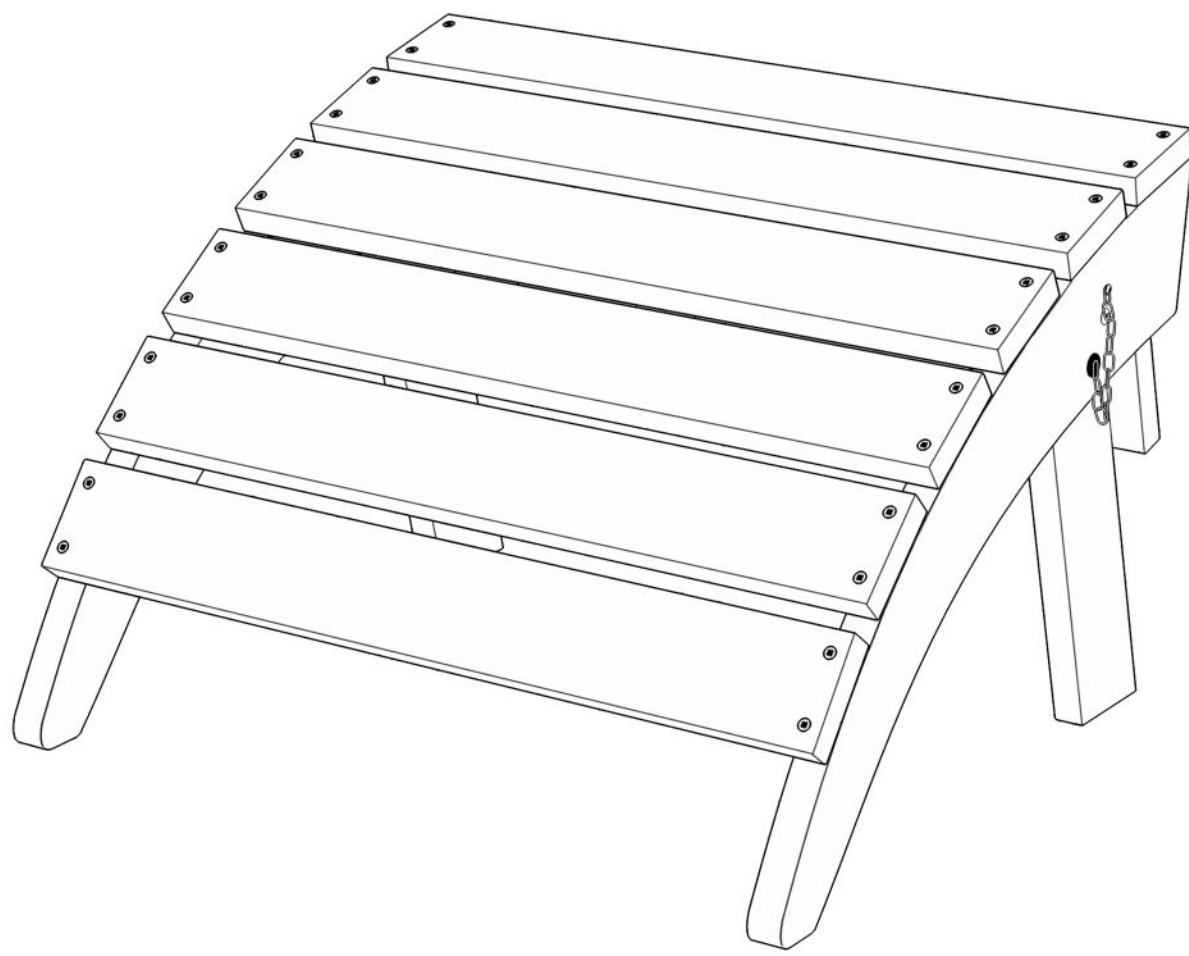

Important - Please read these instructions fully for better using this product.

HASSLE-FREE WARRANTY
Serwall stand behind the quality of our products.
For full warranty policy, email: SERWALL@patioadirondack.com

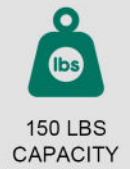

Safety & Care Advice

If you need help or have damaged or missing parts,
please email: SERWALL@patioadirondack.com

Important - Please read these instructions fully for better using this product.

- | | |
|---|---|
| <p>Check you have all the components and tools listed on the pages 3.</p> <p>Remove all fittings from the plastic bags and separate them into their groups.</p> <p>Keep children and animals away from the work area, small parts may cause choking if swallowed.</p> <p>Make sure you have enough space to layout the parts before starting.</p> <p>Assemble on a soft level surface to avoid damaging the unit or your floor.</p> | <p>Do not stand or put weight on the product, this could cause damage.</p> <p>Assemble the item as close to its final position (in the same area) as possible.</p> <p>Do not place furniture directly in front of radiators, fires or any other source of heat.</p> |
|---|---|

General care & maintenance

- | | |
|---|---|
| <p>Using damp cloth and mild detergent for routine maintenance, do not use blench or abrasive cleaners.</p> | <p>From time to time check that there are no loose screws on this unit.</p> |
|---|---|

Clean & Sanitize Tips

- Use this method for a quick clean-up here and there throughout the season — adding in the bleach solution to easily sanitize and eliminate any stubborn stains or dirt build-up from the winter months.
- Mix mild dish soap and warm water in a bucket.
 - Use a clean cloth to wipe the soapy mixture onto the surfaces of your furniture, cleaning off any dirt.
 - For extra cleaning power or to sanitize, mix 1/3 bleach and 2/3 water.
 - Apply bleach mixture to furniture with a clean cloth and allow it to sit on the lumber for a few minutes (this will not affect the color).
 - Loosen any dirt and debris that may catch in the surface grooves of the lumber by scrubbing the bleach mixture with a soft-bristle brush.
 - Rinse thoroughly using a garden hose with a spray nozzle.

Using Instruction

If you need help or have damaged or missing parts,
please email: SERWALL@patioadirondack.com

Unfolding the Ottoman

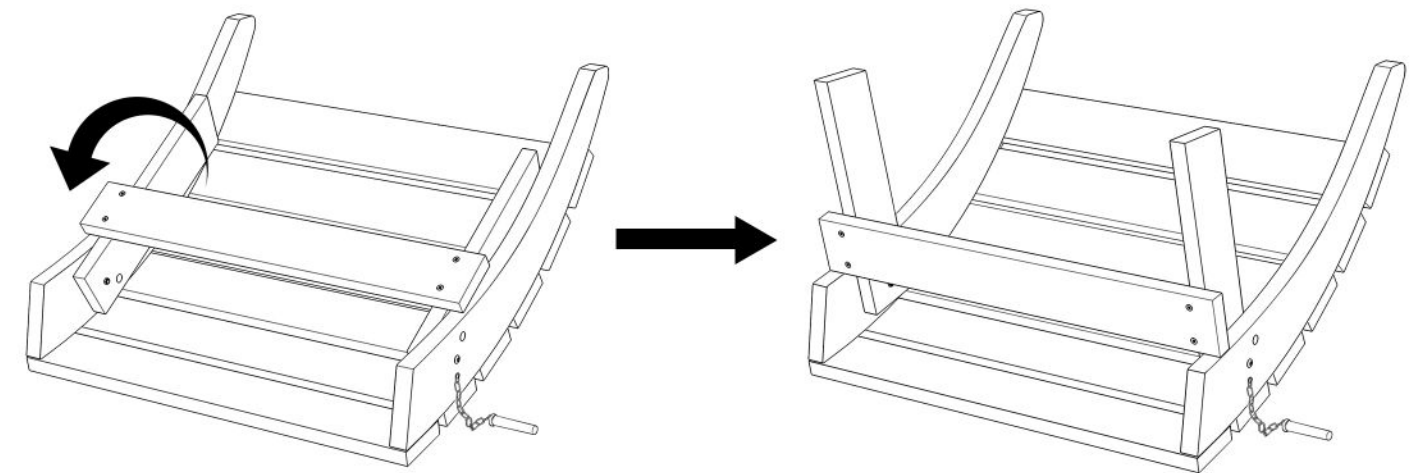

Step 1: Unfold the legs.

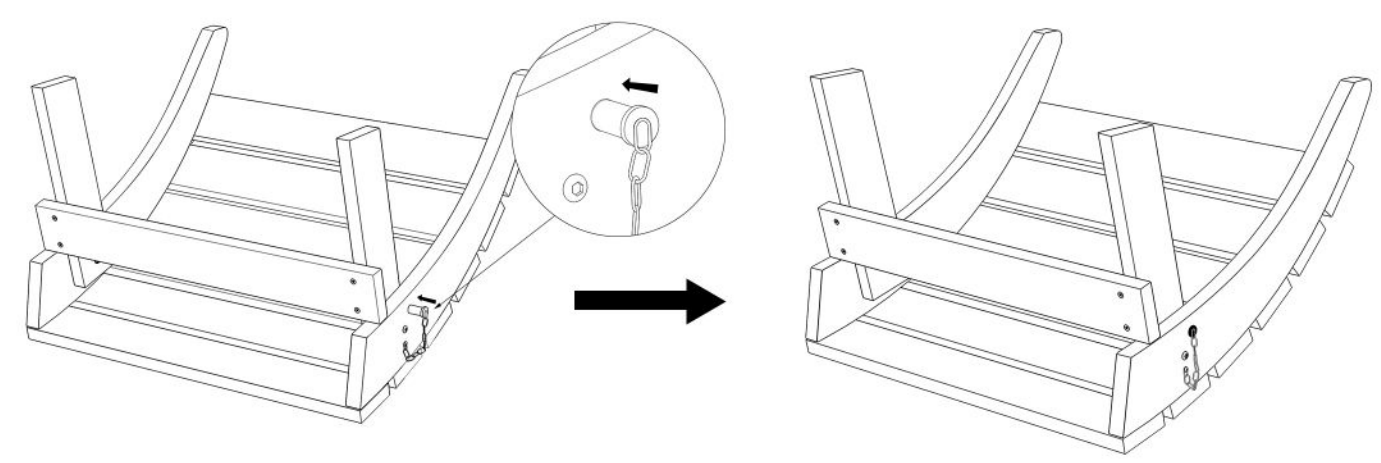

Step 2: Insert the plug.

Using Instruction

If you need help or have damaged or missing parts,
please email: SERWALL@patioadirondack.com

Folding the Ottoman

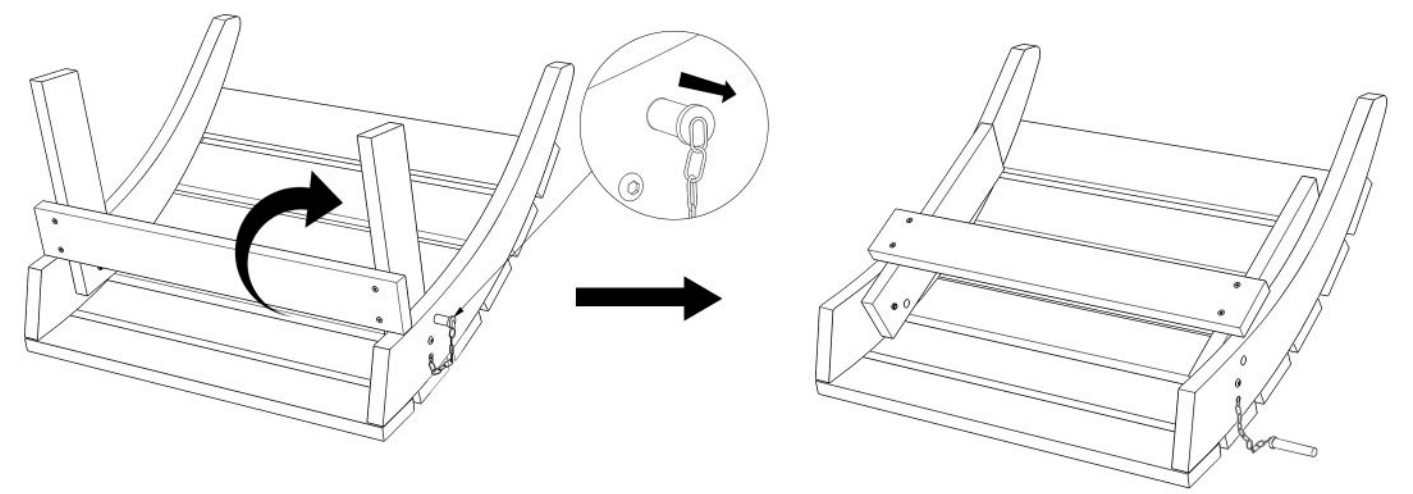

Pull out the plug, then fold the legs.



Folded ottoman can be stored under the reclining chair as shown.